

Schedule 4 Fees and Charges @ Kanangra Hostel

Whilst the Australian Government provides some funding for residential services to assist with the costs associated with providing care, most residents will pay some additional fees & charges.

The Department of Human Services has a scheduled fee increase twice yearly – 20th March & 20th September.

As a not-for-profit, we are committed to providing accommodation and services to elderly people assessed by the Government as requiring care.

If your income and assets are over a certain amount you may be asked to make an accommodation payment that you agree with the home prior to entry.

From 1st July 2014 the Accommodation payment can be made as a lump sum called a Refundable Accommodation Deposit (RAD) or as a Daily Accommodation Payment (DAP).

It can also be a combination of a RAD and a DAP.

Kanangra Hostel has single rooms, with ensuite. Residents are welcome to bring their own furniture when they move in, such as a favourite chest of drawers or armchair for reading. Kanangra Hostel provides a bed and wardrobe.

Faulkner Wing Room

- Single room are balcony connected with attractive views, with private ensuite
- Well maintained and lit rooms with painted wall and carpeted floor
- Electric high/low bed and appropriate furniture and storage areas
- Private ensuite furnished with bathroom amenities, grab rails and wheel chair assessible
- Reverse Cycle Air Conditioner and secured window in the room ensures good lighting and temperature

Maximum price for accommodation

Maximum Refundable Accommodation Deposit (RAD) or	\$450,000	or
Maximum Daily Accommodation Payment (DAP) *MPIR=8.38% from 01/01/2024	\$103.31	

Example of a combination payment

50% of the accommodation payment as a refundable deposit (RAD) and	\$225,000	and
50% of the accommodation payment by periodic daily payments (DAP)	\$51.65	

Typical Layout 1:50

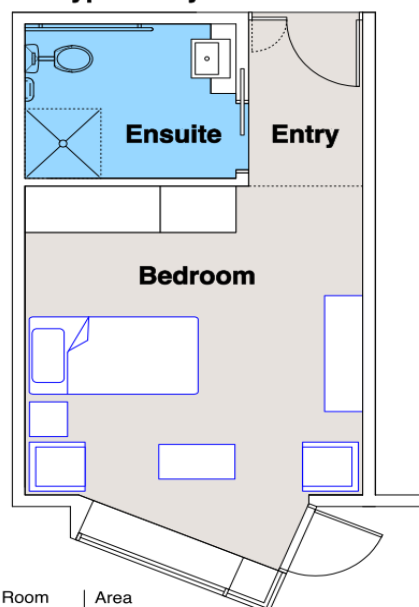

Room	Area
Bedroom	20.35 sqm
Ensuite	4.86 sqm

Schedule 4 Fees and Charges @ Kanangra Hostel

Whilst the Australian Government provides some funding for residential services to assist with the costs associated with providing care, most residents will pay some additional fees & charges.

The Department of Human Services has a scheduled fee increase twice yearly – 20th March & 20th September.

As a not-for-profit, we are committed to providing accommodation and services to elderly people assessed by the Government as requiring care.

If your income and assets are over a certain amount you may be asked to make an accommodation payment that you agree with the home prior to entry.

From 1st July 2014 the Accommodation payment can be made as a lump sum called a Refundable Accommodation Deposit (RAD) or as a Daily Accommodation Payment (DAP).

It can also be a combination of a RAD and a DAP.

Kanangra Hostel has single rooms, with ensuite. Residents are welcome to bring their own furniture when they move in, such as a favourite chest of drawers or armchair for reading. Kanangra Hostel provides a bed and wardrobe.

Quamby Wing Room

- Single room with private ensuite
- Well maintained and lit rooms with painted wall and carpeted floor
- Electric high/low bed and appropriate furniture and storage areas
- Private ensuite furnished with bathroom amenities, grab rails and wheel chair assessable
- Reverse Cycle Air Conditioner and secured window in the room ensures good lighting and temperature

Maximum price for accommodation

Maximum Refundable Accommodation Deposit (RAD) or	\$450,000	or
Maximum Daily Accommodation Payment (DAP) *MPIR=8.38% from 01/01/2024	\$103.31	

Example of a combination payment

50% of the accommodation payment as a refundable deposit (RAD) and	\$225,000	and
50% of the accommodation payment by periodic daily payments (DAP)	\$51.65	

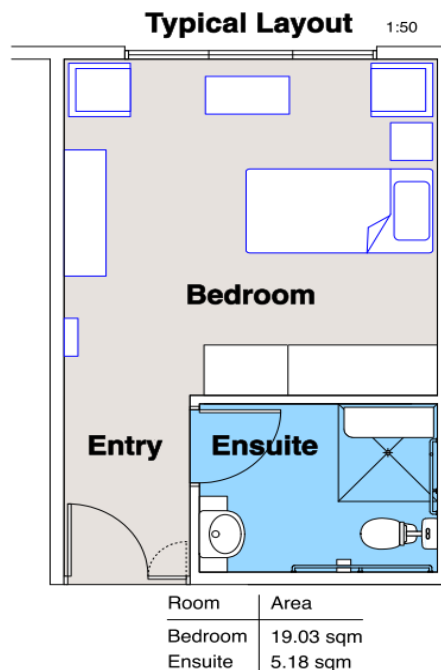

Schedule 4 Fees and Charges @ Kanangra Hostel

Whilst the Australian Government provides some funding for residential services to assist with the costs associated with providing care, most residents will pay some additional fees & charges.

The Department of Human Services has a scheduled fee increase twice yearly – 20th March & 20th September.

As a not-for-profit, we are committed to providing accommodation and services to elderly people assessed by the Government as requiring care.

If your income and assets are over a certain amount you may be asked to make an accommodation payment that you agree with the home prior to entry.

From 1st July 2014 the Accommodation payment can be made as a lump sum called a Refundable Accommodation Deposit (RAD) or as a Daily Accommodation Payment (DAP).

It can also be a combination of a RAD and a DAP.

Kanangra Hostel has single rooms, with ensuite. Residents are welcome to bring their own furniture when they move in, such as a favourite chest of drawers or armchair for reading. Kanangra Hostel provides a bed and wardrobe.

Kanangra Classic Mountain View Room

- Single mountain view room with private ensuite
- Well maintained and lit rooms with painted wall and carpeted floor
- Electric high/low bed and appropriate furniture and storage areas
- Private ensuite furnished with bathroom amenities, grab rails and wheel chair assessable
- Reverse Cycle Air Conditioner and secured window in the room ensures good lighting and temperature

Maximum price for accommodation

Maximum Refundable Accommodation Deposit (RAD) or	\$375,000	or
Maximum Daily Accommodation Payment (DAP) *MPIR=8.38% from 01/01/2024	\$86.09	

Example of a combination payment

50% of the accommodation payment as a refundable deposit (RAD) and	\$187,500	and
50% of the accommodation payment by periodic daily payments (DAP)	\$43.04	

Typical Layout 1:50

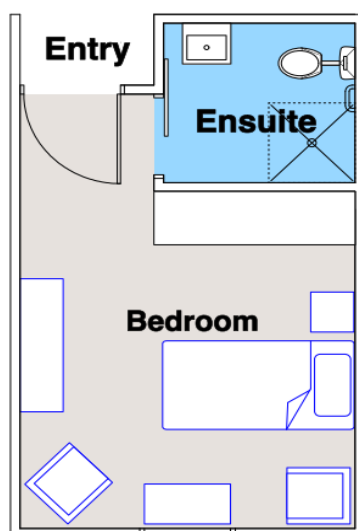

Room	Area
Bedroom	14.84 sqm
Ensuite	3.6 sqm

Schedule 4 Fees and Charges for Kanangra Hostel

Whilst the Australian Government provides some funding for residential services to assist with the costs associated with providing care, most residents will pay some additional fees & charges.

The Department of Human Services has a scheduled fee increase twice yearly – 20th March & 20th September.

As a not-for-profit, we are committed to providing accommodation and services to elderly people assessed by the Government as requiring care.

If your income and assets are over a certain amount you may be asked to make an accommodation payment that you agree with the home prior to entry.

From 1st July 2014 the Accommodation payment can be made as a lump sum called a Refundable Accommodation Deposit (RAD) or as a Daily Accommodation Payment (DAP).

It can also be a combination of a RAD and a DAP.

Kanangra Hostel has single rooms, with ensuite. Kanangra Hostel provides a bed and locked bedside table. Residents should provide their own comfortable chair and any other furnishings to decorate the room to their taste, ensuring enough space to maintain mobility.

Kanangra Classic Room

- Single room with private ensuite
- Well maintained and lit rooms with painted walls and carpeted floor
- Electric high/low bed and appropriate furniture and storage areas
- Private ensuite furnished with bathroom amenities, grab rails and wheel chair assessible
- Reverse cycle heating and secured window in the room ensures good lighting and temperature

Maximum price for accommodation

Maximum Refundable Accommodation Deposit (RAD) or	\$325,000	or
Maximum Daily Accommodation Payment (DAP) *MPIR=8.38% from 01/01/2024	\$74.61	

Example of a combination payment

50% of the accommodation payment as a refundable deposit (RAD) and	\$162,500	and
50% of the accommodation payment by periodic daily payments (DAP)	\$37.30	

Typical Layout 1:50

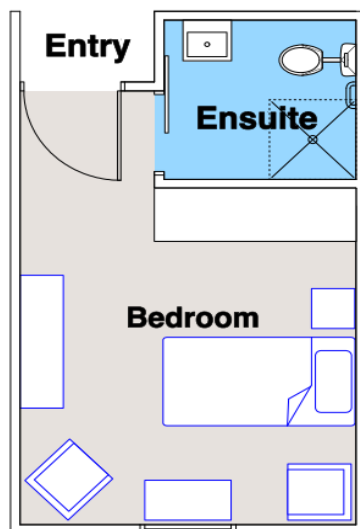

Room	Area
Bedroom	14.84 sqm
Ensuite	3.6 sqm