

## *Schedule 4      Fees and Charges @ Grenoch Home*

**Whilst the Australian Government provides some funding for residential services to assist with the costs associated with providing care, most residents will pay some additional fees & charges.**

The Department of Human Services has a scheduled fee increase twice yearly – 20<sup>th</sup> March & 20<sup>th</sup> September.

As a not-for-profit, we are committed to providing accommodation and services to elderly people assessed by the Government as requiring care.

If your income and assets are over a certain amount you may be asked to make an accommodation payment that you agree with the home prior to entry.

From 1st July 2014 the Accommodation payment can be made as a lump sum called a Refundable Accommodation Deposit (RAD) or as a Daily Accommodation Payment (DAP).

It can also be a combination of a RAD and a DAP.

Grenoch Home has single rooms, with ensuite. Residents are welcome to bring their own furniture when they move in, such as a favourite chest of drawers or armchair for reading. Grenoch Homes provides a bed and wardrobe.

### **Grenoch River View Room**

- Single mountain & town view room with private ensuite
- Well maintained and lit rooms with painted wall and carpeted/vinyl floor
- Electric high/low bed and appropriate furniture and storage areas
- Private ensuite furnished with bathroom amenities, grab rails and wheel chair assessible
- Reverse Cycle Air Conditioner and secured window in the room ensures good lighting and temperature

### **Maximum price for accommodation**

Maximum Refundable Accommodation Deposit (RAD) <b>or</b>	\$425,000 <b>or</b>
Maximum Daily Accommodation Payment (DAP) *MPIR=6.31% from 01/10/2022	\$73.47

### **Example of a combination payment**

50% of the accommodation payment as a refundable deposit (RAD) <b>and</b>	\$212,500 <b>and</b>
50% of the accommodation payment by periodic daily payments (DAP)	\$36.73

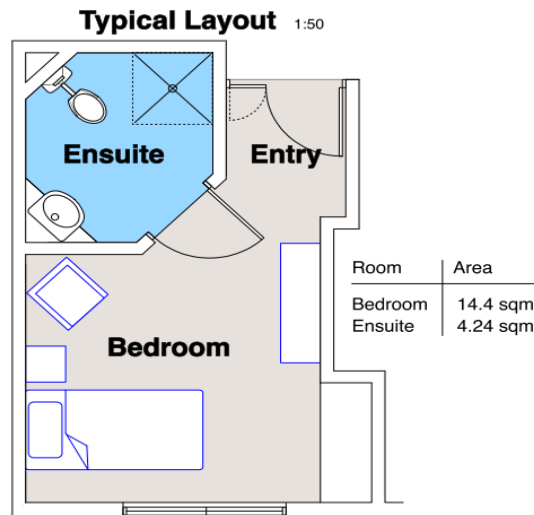

## Schedule 4 Fees and Charges @ Grenoch Home

Whilst the Australian Government provides some funding for residential services to assist with the costs associated with providing care, most residents will pay some additional fees & charges.

The Department of Human Services has a scheduled fee increase twice yearly – 20<sup>th</sup> March & 20<sup>th</sup> September.

As a not-for-profit, we are committed to providing accommodation and services to elderly people assessed by the Government as requiring care.

If your income and assets are over a certain amount you may be asked to make an accommodation payment that you agree with the home prior to entry.

From 1st July 2014 the Accommodation payment can be made as a lump sum called a Refundable Accommodation Deposit (RAD) or as a Daily Accommodation Payment (DAP).

It can also be a combination of a RAD and a DAP.

Grenoch Home has single rooms, with ensuite. Residents are welcome to bring their own furniture when they move in, such as a favourite chest of drawers or armchair for reading. Grenoch Homes provides a bed and wardrobe.

### **Grenoch Garden View Room**

- Single mountain & town view room with private ensuite
- Well maintained and lit rooms with painted wall and carpeted/vinyl floor
- Electric high/low bed and appropriate furniture and storage areas
- Private ensuite furnished with bathroom amenities, grab rails and wheel chair assessible
- Reverse Cycle Air Conditioner and secured window in the room ensures good lighting and temperature

### **Maximum price for accommodation**

Maximum Refundable Accommodation Deposit (RAD) <b>or</b>	\$350,000 <b>or</b>
Maximum Daily Accommodation Payment (DAP) *MPIR=6.31% from 01/10/2022	\$60.50

### **Example of a combination payment**

50% of the accommodation payment as a refundable deposit (RAD) <b>and</b>	\$175,000 <b>and</b>
50% of the accommodation payment by periodic daily payments (DAP)	\$30.25

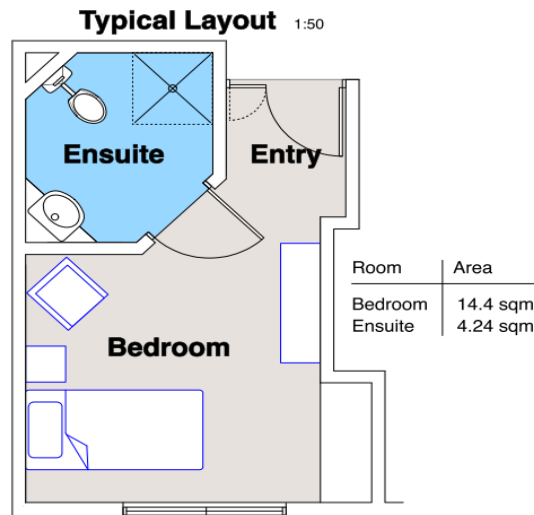

## *Schedule 4      Fees and Charges @ Grenoch Home*

**Whilst the Australian Government provides some funding for residential services to assist with the costs associated with providing care, most residents will pay some additional fees & charges.**

The Department of Human Services has a scheduled fee increase twice yearly – 20<sup>th</sup> March & 20<sup>th</sup> September.

As a not-for-profit, we are committed to providing accommodation and services to elderly people assessed by the Government as requiring care.

If your income and assets are over a certain amount you may be asked to make an accommodation payment that you agree with the home prior to entry.

From 1st July 2014 the Accommodation payment can be made as a lump sum called a Refundable Accommodation Deposit (RAD) or as a Daily Accommodation Payment (DAP).

It can also be a combination of a RAD and a DAP.

Grenoch Home has single rooms, with ensuite. Residents are welcome to bring their own furniture when they move in, such as a favourite chest of drawers or armchair for reading. Grenoch Homes provides a bed and wardrobe.

### **Grenoch Classic Room**

- Single courtyard view room with private ensuite
- Well maintained and lit rooms with painted wall and carpeted/vinyl floor
- Electric high/low bed and appropriate furniture and storage areas
- Private ensuite furnished with bathroom amenities, grab rails and wheel chair assessible
- Reverse Cycle Air Conditioner and secured window in the room ensures good lighting and temperature

### **Maximum price for accommodation**

Maximum Refundable Accommodation Deposit (RAD) <b>or</b>	\$350,000 <b>or</b>
Maximum Daily Accommodation Payment (DAP) *MPIR=6.31% from 01/10/2022	\$60.50

### **Example of a combination payment**

50% of the accommodation payment as a refundable deposit (RAD) <b>and</b>	\$175,000 <b>and</b>
50% of the accommodation payment by periodic daily payments (DAP)	\$30.25

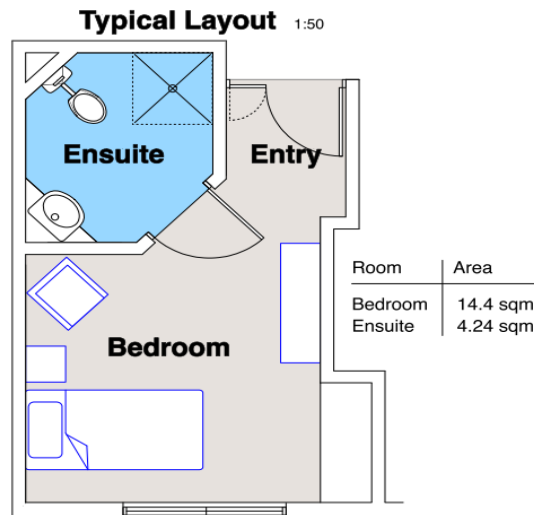

## Schedule 4 Fees and Charges @ Grenoch Home

Whilst the Australian Government provides some funding for residential services to assist with the costs associated with providing care, most residents will pay some additional fees & charges.

The Department of Human Services has a scheduled fee increase twice yearly – 20<sup>th</sup> March & 20<sup>th</sup> September.

As a not-for-profit, we are committed to providing accommodation and services to elderly people assessed by the Government as requiring care.

If your income and assets are over a certain amount you may be asked to make an accommodation payment that you agree with the home prior to entry.

From 1st July 2014 the Accommodation payment can be made as a lump sum called a Refundable Accommodation Deposit (RAD) or as a Daily Accommodation Payment (DAP).

It can also be a combination of a RAD and a DAP.

Grenoch Home has single rooms, with ensuite. Residents are welcome to bring their own furniture when they move in, such as a favourite chest of drawers or armchair for reading. Grenoch Homes provides a bed and wardrobe.

### **Grenoch Twin Room**

- Single room with shared ensuite
- Well maintained and lit rooms with painted wall and carpeted/vinyl floor
- Electric high/low bed and appropriate furniture and storage areas
- Private ensuite furnished with bathroom amenities, grab rails and wheel chair assessible
- Reverse Cycle Air Conditioner and secured window in the room ensures good lighting and temperature

### **Maximum price for accommodation**

Maximum Refundable Accommodation Deposit (RAD) **or** \$300,000 **or**  
Maximum Daily Accommodation Payment (DAP) \*MPIR=6.31% from 01/10/2022 \$51.86

### **Example of a combination payment**

50% of the accommodation payment as a refundable deposit (RAD) **and** \$150,000 **and**  
50% of the accommodation payment by periodic daily payments (DAP) \$25.93

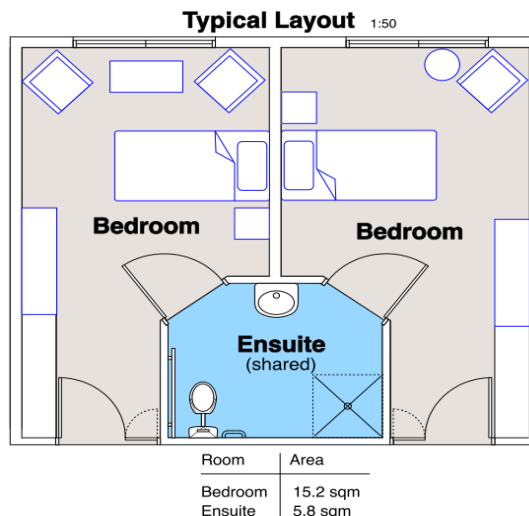

## *Schedule 4      Fees and Charges @ Grenoch Home*

**Whilst the Australian Government provides some funding for residential services to assist with the costs associated with providing care, most residents will pay some additional fees & charges.**

The Department of Human Services has a scheduled fee increase twice yearly – 20<sup>th</sup> March & 20<sup>th</sup> September.

As a not-for-profit, we are committed to providing accommodation and services to elderly people assessed by the Government as requiring care.

If your income and assets are over a certain amount you may be asked to make an accommodation payment that you agree with the home prior to entry.

From 1st July 2014 the Accommodation payment can be made as a lump sum called a Refundable Accommodation Deposit (RAD) or as a Daily Accommodation Payment (DAP).

It can also be a combination of a RAD and a DAP.

Grenoch Home has single rooms, with ensuite. Residents are welcome to bring their own furniture when they move in, such as a favourite chest of drawers or armchair for reading. Grenoch Homes provides a bed and wardrobe.

### **McNeil House Room 1 - 4**

- Single room with shared ensuite
- Well maintained and lit rooms with painted wall and carpeted/vinyl floor
- Electric high/low bed and appropriate furniture and storage areas
- Private ensuite furnished with bathroom amenities, grab rails and wheel chair assessable
- Reverse Cycle Air Conditioner and secured window in the room ensures good lighting and temperature
- Designed to support those with various forms of dementia in a safe & secure environment

### **Maximum price for accommodation**

Maximum Refundable Accommodation Deposit (RAD) **or** \$350,000 **or**  
 Maximum Daily Accommodation Payment (DAP) \*MPIR=6.31% from 01/10/2022 \$60.50

### **Example of a combination payment**

50% of the accommodation payment as a refundable deposit (RAD) **and** \$175,000 **and**  
 50% of the accommodation payment by periodic daily payments (DAP) \$30.25

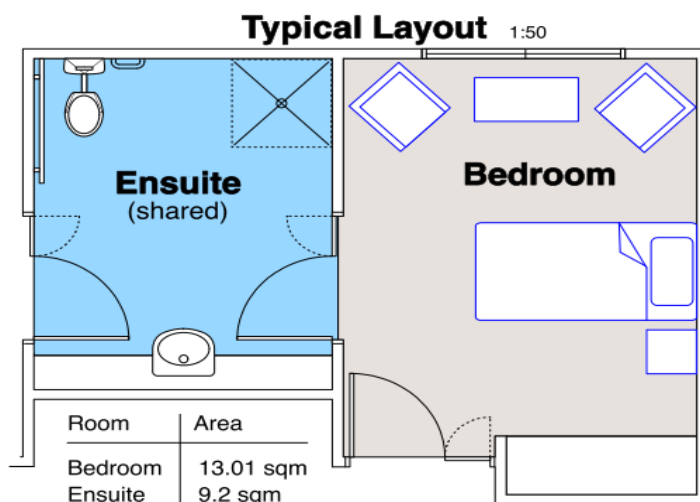

## *Schedule 4      Fees and Charges @ Grenoch Home*

**Whilst the Australian Government provides some funding for residential services to assist with the costs associated with providing care, most residents will pay some additional fees & charges.**

The Department of Human Services has a scheduled fee increase twice yearly – 20<sup>th</sup> March & 20<sup>th</sup> September.

As a not-for-profit, we are committed to providing accommodation and services to elderly people assessed by the Government as requiring care.

If your income and assets are over a certain amount you may be asked to make an accommodation payment that you agree with the home prior to entry.

From 1st July 2014 the Accommodation payment can be made as a lump sum called a Refundable Accommodation Deposit (RAD) or as a Daily Accommodation Payment (DAP).

It can also be a combination of a RAD and a DAP.

Grenoch Home has single rooms, with ensuite. Residents are welcome to bring their own furniture when they move in, such as a favourite chest of drawers or armchair for reading. Grenoch Homes provides a bed and wardrobe.

### **McNeil House Room 5 - 8**

- Single room with private ensuite
- Well maintained and lit rooms with painted wall and carpeted/vinyl floor
- Electric high/low bed and appropriate furniture and storage areas
- Private ensuite furnished with bathroom amenities, grab rails and wheel chair assessable
- Reverse Cycle Air Conditioner and secured window in the room ensures good lighting and temperature
- Designed to support those with various forms of dementia in a safe & secure environment

### **Maximum price for accommodation**

Maximum Refundable Accommodation Deposit (RAD) <b>or</b>	\$350,000 <b>or</b>
Maximum Daily Accommodation Payment (DAP) *MPIR=6.31% from 01/10/2022	\$60.50

### **Example of a combination payment**

50% of the accommodation payment as a refundable deposit (RAD) <b>and</b>	\$175,000 <b>and</b>
50% of the accommodation payment by periodic daily payments (DAP)	\$30.25

